



Critical Care
Product catalog

evercare® inLine

The evercare® inLine series of infusion therapy products is a result of years of product development with high quality materials and latest technology. Special attention has been paid to adaptation to Nordic requirements. Every product is delivered with a high degree of knowledge about its proper use in the therapy.

The evercare® inLine infusion assortment includes:

- Gravity sets
- Filterstop gravity sets
- TIVA sets
- MONOSETS
- DUOSETS
- Transfusion sets
- Extension lines
- 3-way stopcocks
- 3-way stopcocks with extension lines

Certifications:

evercare® inLine products are CE marked and manufactured according to EN ISO product and quality standards.

CE 2460

The product complies with legal requirements for medical devices.

Notified body Det Norske Veritas.

Materials

The main raw materials of evercare® inLine infusion products are polyolefine plastic material and DEHP-free PVC – both specifically designed for medical devices. None of the materials used in evercare® inLine products contains carcinogenic, mutagenic or toxic substances, including any of the Substances of Very High Concern (SVHC) as listed in the latest available version of the Candidate List published by European Chemicals Agency (ECHA).

- Phthalate free – no plasticizer diffusion
- Excellent kink resistant, soft and flexible
- Highly resistant to chemicals -> low drug absorption
- With excellent optical properties, highly transparent
- State-of-the-art roller clamp
- All infusion sets with PVC-free, easy to fill, X-large and safe drip chamber

Environmentally friendly materials

PVC (vinyl plastic) is used throughout health care in a wide variety of applications, from IV bags and disposable gloves, to curtains and flooring. Today it is the most commonly used plastic in medical devices.

However, the use of PVC creates a number of environmental and health risks — including dioxin pollution and patient exposure to hazardous chemicals such as the plasticizer phthalate DEHP, which may leach from vinyl medical devices.

In the European Union, the use of Di(2-ethylhexyl)phthalate (DEHP) in medical devices has been under serious pressure. DEHP is classified as a category 2 reproductive toxin, thus it is a CMR (Carcinogenic, Mutagenic or Toxic for Reproduction) substance.

With effect from March 2010, all medical devices containing phthalates must be labelled as such for use in the European Union. This is in accordance with the consolidated Medical Devices Directive 93/42/EEC, as amended by Directive 2007/47/EC.

Due to these concerns, many health care facilities around the world are switching to safer, cost-effective medical devices that do not contain vinyl plastic or phthalate plasticizer.

OneMed's choice for PVC free evercare® inLine is a polyolefin based thermoplastic elastomer (TPE) that is specially developed for medical applications.

From health point of view the main benefits with TPE are:

- Low migration -> no plasticizer migration
- Low drug absorption -> due to high chemical resistance
- Does not contain latex, BPA (bisphenol A), phthalates, or Substances of Very High Concern as listed in the REACH Regulation

Environmentally TPE offers following advantages:

- PVC-free -> chlorine free -> dioxin free
- Lower density -> lower material consumption-> reduced waste
- Better environmental profile (vs PVC (polyvinyl chlorine) and TPU/PUR (thermoplastic polyurethane/polyurethane)).

All evercare® inLine products are PVC-free or DEHP-free PVC. The plasticizer in evercare® DEHP-free PVC products is a non-phthalate plasticizer.

Difference between filters

Generals about evercare® filters

- » Universal spike, fits all types of containers
- » Air-vent with bacteria retention filter
- » Extra large, transparent and easy to fill drip chamber
- » Easy to detect drops from distance
- » 20 drops/ml
- » 15 µm fluid filter protect the patient from particles
- » Kink-resistant clear tubing
- » Easy detection of air bubbles



Air vent filter

- Air-vent bacteria retention filter
- Prevent leakage from aerosols
- 0,2 µm pore size
- Always closed when unpacked

Fluid particle filter

- Universal spike, fits all types of containers
- 15 µm fluid filter protect the patient from particles going intravascular



Filterstop gravity set

Unique filter in the drip chamber reduces the risk of air passing through the filter into the tube when infusion is completed.

Other features:

- Possibility to use the same set for next infusion
- No need for flushing

These features make the products both time and cost saving to use.



Blood filter

The large filter area provides a high flow rate during blood transfusion.

- 200 µm pore size
- Retains large particles

Hydrophobic filter

- Ensures that the line fills automatically
- Prevents spill and leakage
- Protect against contamination



inLine components

3-way stopcock

- Lipid resistance for 96 hours
- 45 degree click feature
- Rotating Luer-lock
- Can stand pressure up to 2 bar
- Large and ergonomic wings for easy handling



Symbol for 3-way stopcock
(also found on artwork)

3-way stopcock with needle free connector

All benefits of the stopcock as well as:

- Reduced risk of contamination
- Easily swabable



Back check valve

- Tolerates up to 6 bar pressure
- Coloured back-check valves for easy detection
- Optimal security when parallel infusion



Luer-lock

- All sets with rotating luer lock (except Essentia and BCV)
- Safe and easy connection without twisting the tube
- All sets with hydrophobic filter
- Easy, time saving and safe priming
- Protects against contamination



Symbol for luer-lock
(also found on artwork)

Needle free connector

- Needle-free connector
- Can be wiped up to 300 times
- Luer and Luer-lock



Symbol for needle free connector
(also found on artwork)



Roller clamp

- Our own designed roller-clamp for maximum high precision.
- High precision and accurate flow rate
- Safe, user friendly tube dock
- Large span for precise adjustment



Gravity sets

evercare® inLine standard gravity sets is produced both with and without air-vent function. Suitable for both plastic and glass containers. Closed hatch when delivered. Suitable for glass bottles and vials. The non-vented gravity sets are suitable for infusion with plastic bags or bottles and no need for venting and to avoid risk of air infusion.

Some feature benefits:

- Tube length 180, 220 and 320 cm
- Our own designed precise roller-clamp
- With or without 3-way stopcock
- With or without back check valve
- With or without needle free connector
- Prime Stop for easy priming without spillage
- Rotating luer-lock for easy handling



Standard gravity sets

Vented gravity sets, PVC free				
REF	Product name	Features	Tube length cm	Pack count
10500-01	Gravity set, vented		180	1/20/80
10501-01	Gravity set, vented		220	1/20/80
10502-01	Gravity set, vented		320	1/15/60
10507-01	Gravity set, vented	needle free connector	180	1/20/80
10570-01	Gravity set, vented	back check valve	180	1/20/80
10503-01	Gravity set, vented	back check valve	320	1/15/60

Vented gravity sets, DEHP free				
REF	Product name	Features	Tube length cm	Pack count
10250-01	Gravity set, vented		180	1/20/80
10341-01	Gravity set, vented		220	1/20/80
10251-01	Gravity set, vented		320	1/15/60
10255-01	Gravity set, vented	needle free connector	180	1/20/80
10256-01	Gravity set, vented	back check valve	180	1/20/80
10257-01	Gravity set, vented	back check valve	320	1/15/60

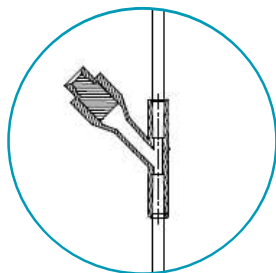

Products with needle free connector:
REF 10507-01, 10255-01

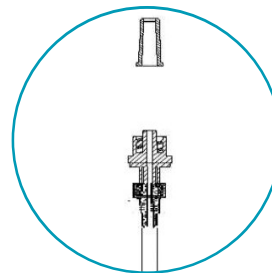

Products with back check valve:
REF 10570-01, 10503-01, 10256-01, 10257-01

Non-vented gravity sets, PVC free				
REF	Product name	Features	Tube length cm	Pack count
10508-01	Gravity set, non-vented		180	1/20/80
10509-01	Gravity set, non-vented		220	1/20/80
10510-01	Gravity set, non-vented		320	1/15/60
10513-01	Gravity set, non-vented	needle free connector	180	1/20/80

Non-vented gravity sets, DEHP free				
REF	Product name	Features	Tube length cm	Pack count
10260-01	Gravity set, non-vented		180	1/20/80
10343-01	Gravity set, non-vented		220	1/20/80
10261-01	Gravity set, non-vented		320	1/15/60
10263-01	Gravity set, non-vented	needle free connector	180	1/20/80

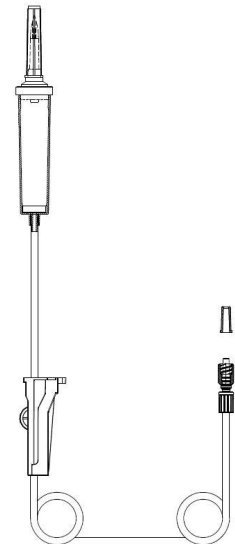

Illustration of non-vented gravity sets:
REF 10508-01, 10509-01, 10510-01,
10260-01, 10343-01, 10261-01

Gravity sets with 3-way stopcock

3-way stopcock for easy injections or parallel infusions and for easy disconnection of the infusion line and still use of the stopcock.

Optional needle free connector for safety and less risk of contamination. Back check valve for optimal security during parallel infusion.

Vented gravity sets with 3-way stopcock, PVC free				
REF	Product name	Features	Tube length cm	Pack count
10504-01	Gravity set, vented	3-way stopcock	180 + 15	1/20/80
10505-01	Gravity set, vented	3-way stopcock	220 + 15	1/20/80
10506-01	Gravity set, vented	3-way stopcock	320 + 15	1/15/60
10579-01	Gravity set, vented	3-way stopcock, back check valve	180 + 15	1/20/80
10582-01	Gravity set, vented	3-way stopcock, needle free connector	180 + 15	1/20/80
10585	Gravity set, vented	3-way stopcock, needle free connector, back check valve	180 + 15	1/20/80

Vented gravity sets with 3-way stopcock, DEHP free				
REF	Product name	Features	Tube length cm	Pack count
10254-01	Gravity set, vented	3-way stopcock	180 + 15	1/20/80
10342-01	Gravity set, vented	3-way stopcock	220 + 15	1/20/80
10258-01	Gravity set, vented	3-way stopcock, back check valve	180 + 15	1/20/80
10259-01	Gravity set, vented	3-way stopcock, back check valve	320 + 15	1/15/60

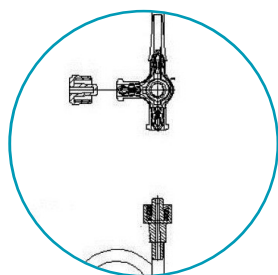

Products with 3-way stopcock:
REF 10504-01, 10505-01,
10506-01, 10254-01, 10342-01

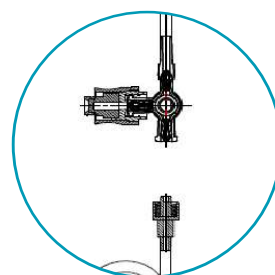

Products with 3-way stopcock and
needle free connector:
REF 10582-01

Non-vented gravity sets with 3-way stopcock, PVC free				
REF	Product name	Features	Tube length cm	Pack count
10511-01	Gravity set, non-vented	3-way stopcock	180 + 15	1/20/80
10512-01	Gravity set, non-vented	3-way stopcock	220 + 15	1/20/80
10514-01	Gravity set, non-vented	3-way stopcock, back check valve	180 + 15	1/20/80

Non-vented gravity sets with 3-way stopcock

REF 10262-01

Gravity set, non-vented, DEHP free

Features: 3-way stopcock

Tube length: 180 + 15 cm

Pack count: 1/20/80

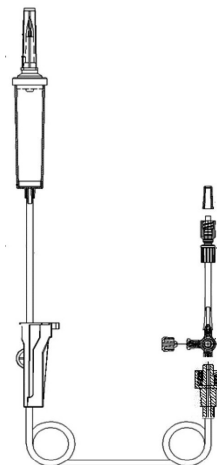

Gravity sets with 3-way stopcock, glued

3-way stopcock for easy injections or parallel infusions and safety of accidental disconnection of the stopcock.

Optional needle free connector for safety and less risk of contamination and back check valve for optimal security during parallel infusion.

Vented gravity sets with 3-way stopcock, PVC free				
REF	Product name	Features	Tube length cm	Pack count
10577-01	Gravity set, vented	3-way stopcock glued	180 + 15	1/20/80
10578-01	Gravity set, vented	3-way stopcock glued	320 + 15	1/15/60
10580-01	Gravity set, vented	3-way stopcock glued, back check valve	180 + 15	1/20/80
10581-01	Gravity set, vented	3-way stopcock glued, back check valve	320 + 15	1/15/60

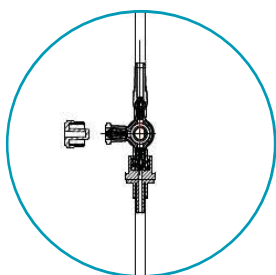

Products with glued 3-way stopcock and back check valve:
REF 10580-01, 10581-01

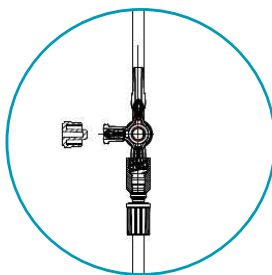

Products with glued 3-way stopcock:
REF 10577-01, 10578-01

Non-vented gravity sets with 3-way stopcock, glued

REF 10572-01

Gravity set, non-vented, PVC free

Features: 3-way stopcock glued

Tube length: 180 + 15 cm

Pack count: 1/20/80

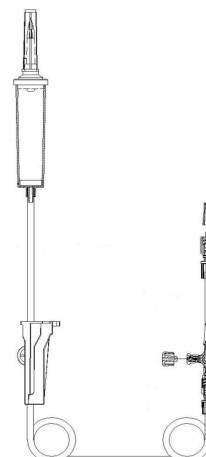

Filterstop Gravity sets

The unique filter in the drip chamber reduces the risk of air passing through the filter into the tube when infusion is completed.

Some feature benefits:

- Tube length 180, 220 and 320 cm
- Our own designed precise roller-clamp
- With or without 3-way stopcock
- With or without back check valve
- With or without needle free connector
- Prime Stop for easy priming without spillage
- Rotating luer-lock for easy handling



These features give the following benefits:

- No need to change the gravity set when new infusion is ordered
- Time saving
- Economical saving, less time and less gravity sets needed
- Safety aspect. Reduces the risk of accidental air infusion
- Environmental aspect. No need of flushing out liquid and drugs to get rid of air bubbles when starting new infusion



Filterstop standard gravity sets

Optional needle free connector for safety and less risk of contamination and back check valve for optimal security during parallel infusion.

Vented filterstop gravity sets, PVC free

REF	Product name	Features	Tube length cm	Pack count
10590	Filterstop Gravity set		180	1/20/80
10591	Filterstop Gravity set		320	1/15/60
10593	Filterstop Gravity set	back check valve	180	1/20/80

Vented filterstop gravity sets, DEHP free

REF	Product name	Features	Tube length cm	Pack count
10350	Filterstop Gravity set		180	1/20/80
10353	Filterstop Gravity set		220	1/20/80
10351	Filterstop Gravity set		320	1/15/60
10354	Filterstop Gravity set	needle free connector	220	1/20/80
10355	Filterstop Gravity set	back check valve	180	1/20/80

Non-vented filterstop gravity sets, PVC free

REF	Product name	Tube length cm	Pack count
10598	Filterstop Gravity set	180	1/20/80
10599	Filterstop Gravity set	320	1/15/60

Filterstop gravity set 3-way stopcock

3-way stopcock for easy injections or parallel infusions and safety of accidental disconnection of the stopcock.

Optional needle free connector for safety and less risk of contamination and back check valve for optimal security during parallel infusion.

Vented filterstop gravity sets with 3-way stopcock

REF 10592

Filterstop Gravity set, PVC free

Features: 3-way stopcock

Tube length: 180 + 15 cm

Pack count: 1/20/80

Vented filterstop gravity sets with 3-way stopcock

REF 10352

Filterstop Gravity set, DEHP free

Features: 3-way stopcock

Tube length: 180 + 15 cm

Pack count: 1/20/80

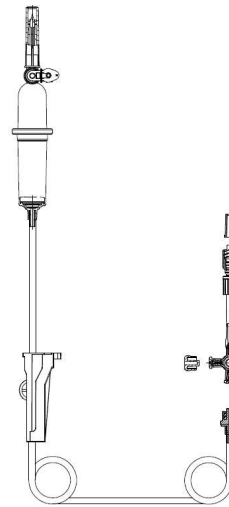

Vented filterstop gravity sets with glued 3-way stopcock, PVC free

REF	Product name	Features	Tube length cm	Pack count
10594	Filterstop Gravity set	3-way stopcock glued	180 + 15	1/20/80
10595	Filterstop Gravity set	3-way stopcock glued, needle free connector	180 + 15	1/20/80
10596	Filterstop Gravity set	3-way stopcock glued, back check valve	180 + 15	1/20/80



REF 10595

Non-vented filterstop gravity sets with glued 3-way stopcock

REF 10597

Filterstop Gravity set, PVC free

Features: 3-way stopcock glued

Tube length: 180 + 15 cm

Pack count: 1/20/80



MONOSETS

MONOSET is a safe system for preparation and administration of antibiotics. By using the system the users avoids spillage and aerosols from hazardous drugs.

- Various configurations
- Aerosol filter for antibiotics
- Hydrophobic filter prevents leakage and exposure to hazardous substances
- Needle free connector for the possibility to mix with sterile water
- Easy identification of the prepared drug, vial connected to the set during administration



MONOSET

Closed system for ad-mixing with aerosol air-vented filter.

MONOSETS with 3-way stopcock, PVC free

REF	Product name	Features	Tube length cm	Pack count
10517-01	MONOSET	1-way, needle free connector	180 + 15	1/15/60
10518-01	MONOSET	1-way, needle free connector, back check valve	180 + 15	1/15/60

MONOSETS without 3-way stopcock, PVC free

REF	Product name	Features	Tube length cm	Pack count
10515-01	MONOSET	1-way	180	1/15/60
10516-01	MONOSET	1-way, needle-free connector	180	1/15/60

DUOSET

Closed system for ad-mixing with aerosol air-vented filter and two vials and all the benefits of monoset.

REF 10576-01

DUOSET 2-way, PVC free

Tube length: 180 cm

Pack count: 1/15/60



MONOSETS closed

MONOSET is a safe and closed system for preparation and administration of antibiotics. By using the system the users avoid spillage and aerosols from hazardous drugs and no spill when disconnecting after infusion.

- Various configurations
- Aerosol filter for antibiotics
- Hydrophobic filter prevents leakage and exposure to hazardous substances
- Needle free connector for the possibility to mix with sterile water
- Easy identification of the prepared drug, vial connected to the set during administration
- Spinning Spiros®, closed male luer, no spillage when set is disconnected
- No leakage from set on waste container.



REF 10583

MONOSET Spinning Spiros, PVC free

Features: 1-way, needle free connector

Tube length: 180 cm

Pack count: 1/15/60

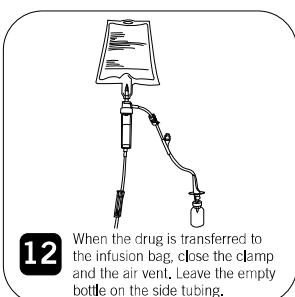
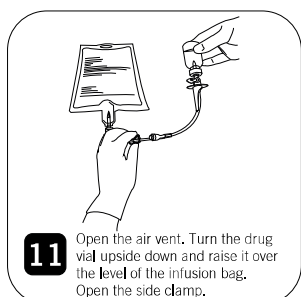
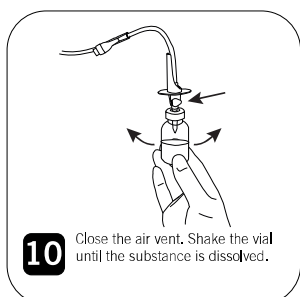
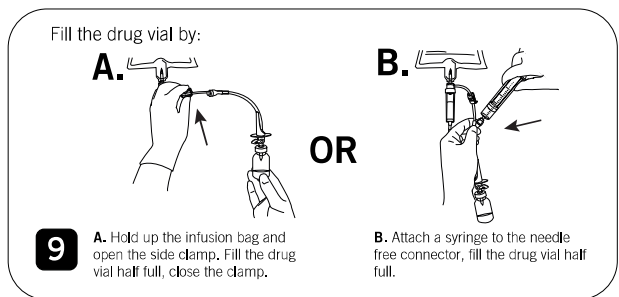
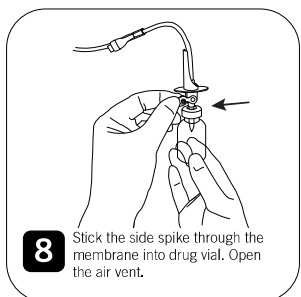
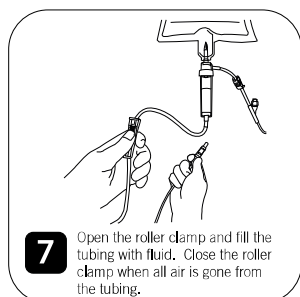
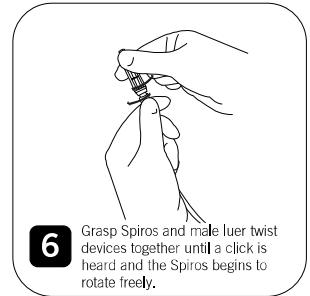
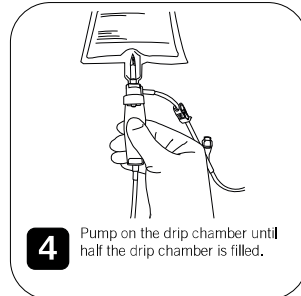
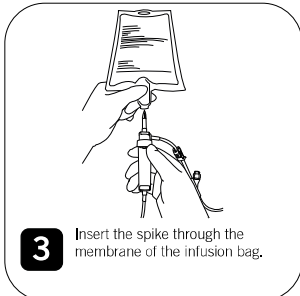
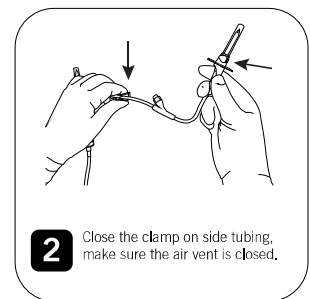
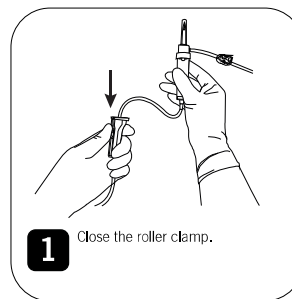

Transfusion sets

evercare® has a wide range of transfusion sets containing quality components adapted to the customers demands and requirements.

- Available in different lengths and features like back check valve, 3-way stopcock and double spike
- Large filter area for filtration and high flowrate
- Hydrophobic filter prevents leakage and exposure to blood components
- Needle free connector



Vented transfusion set, DEHP free

REF 10370

Transfusion set, DEHP free

Tube length: 180 cm

Pack count: 1/20/80

Non-vented transfusion sets, PVC free

REF	Product name	Features	Tube length cm	Pack count
10672	Transfusion set		180	1/20/80
10673	Transfusion set		220	1/15/60
10675	Transfusion set		320	1/15/60
10676	Transfusion set	back check valve	180	1/20/80
10678	Transfusion set	3-way stopcock, back check valve	180 + 15	1/20/80
10680	Transfusion set	double spike	205	1/15/60

Non-vented transfusion sets, DEHP free

REF	Product name	Tube length cm	Pack count
10298	Transfusion set	180	1/20/80
10299	Transfusion set	220	1/20/80
10300	Transfusion set	320	1/15/60

Extension lines

Suitable for extension of infusion lines or connected to a syringe and syringe pump.

- 2 different diameters, Micro 1 x 2 mm and Macro 3 x 4.1 mm
- 2 raw material options, DEHP-free PVC and PVC-free
- Micro 1 x 2 mm diameter high pressure infusion lines for pumps
- Hydrophobic filter for safety and easy handling when priming
- Can stand pressure

Pack count: 1/25/100



Micro extension lines 1 x 2 mm tube diameter, PVC free

REF	Product name	Tube length cm
10526-01	Extension line	50
10527-01	Extension line	150
10528-01	Extension line	200
10529-01	Extension line	300

Macro extension lines 3 x 4.1 mm tube diameter, PVC free

REF	Product name	Tube length cm
10530	Extension line	10
10531	Extension line	30
10532	Extension line	50
10533	Extension line	90
10534	Extension line	100
10535	Extension line	120
10536	Extension line	150
10537	Extension line	200
10538	Extension line	300



Macro extension lines 3 x 4.1 mm tube diameter, DEHP free

REF	Product name	Tube length cm
10271	Extension line	10
10272	Extension line	30
10273	Extension line	50
10274	Extension line	90
10275	Extension line	100
10276	Extension line	120
10277	Extension line	150
10278	Extension line	200
10279	Extension line	300

Extension lines, coiled

The coiled extension lines are especially suitable for children wards and MRI (magnetic resonance imaging).

- One diameter, Micro 1 x 2 mm
- High pressure infusion lines for pumps
- Hydrophobic filter for safety and easy handling when priming

Pack count: 1/25/100

Micro coiled extension lines 1 x 2 mm tube diameter, PVC free

REF	Product name	Tube length cm
10539-01	Extension line, coiled	150
10540-01	Extension line, coiled	200
10541-01	Extension line, coiled	300
10542-01	Extension line, coiled	400



3-way stopcocks

Lipid-resistant for 96 hours. Rotating luer lock. Large wings for easy handling. 45 degree click feature. Product can stand pressure up to 2 bar
Colour: white.

Pack count: 1/50/200



REF 10554-01

3-way stopcocks with needle free connectors

With needle free connector for easily handling and reduced risk of contamination.

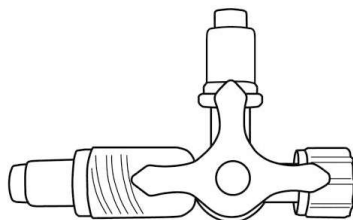

REF 10573-01

Features: 1 needle free connector

Pack count: 1/25/100



REF 10574-01

Features: 2 needle free connectors

Pack count: 1/25/100

3-way stopcocks with extension lines

- Lipid-resistant for 96 hours
- Large ergonomical wings for easy handling
- Rotating luer lock
- Hydrophobic filter
- Can stand pressure up to 2 bar
- 45 degree click feature
- Colour: white



3-way stopcocks with extension lines and needle free connectors

Hydrophobic filter for safety and easy handling when priming.

3-way stopcocks with extension lines and needle free connectors, 3 x 4.1 mm macro tube diameter, PVC free

REF	Product name	Number of needle free connectors	Tube length cm	Pack count
10571-01	Extension line with 3-way stopcock	1	10	1/25/100
10575-01	Extension line with 3-way stopcock	2	10	1/25/100

3-way stopcocks with extension lines

A broad range of products with different lengths for different needs. Fat and alcohol resistance at 96 hours. Hydrophobic filter for safety and easy handling when priming.

Pack count: 1/25/100



3-way stopcocks with extension lines, 3 x 4.1 mm macro tube diameter, PVC free

REF	Product name	Tube length
10548-01	Extension line with 3-way stopcock	10 cm
10549-01	Extension line with 3-way stopcock	30 cm
10550-01	Extension line with 3-way stopcock	50 cm
10551-01	Extension line with 3-way stopcock	60 cm
10552-01	Extension line with 3-way stopcock	90 cm
10553-01	Extension line with 3-way stopcock	100 cm

3-way stopcocks with extension lines, 3 x 4.1 mm macro tube diameter, DEHP free

REF	Product name	Tube length
10287-01	Extension line with 3-way stopcock	7 cm
10288-01	Extension line with 3-way stopcock	10 cm
10289-01	Extension line with 3-way stopcock	15 cm
10290-01	Extension line with 3-way stopcock	25 cm
10291-01	Extension line with 3-way stopcock	30 cm
10292-01	Extension line with 3-way stopcock	50 cm
10293-01	Extension line with 3-way stopcock	60 cm
10294-01	Extension line with 3-way stopcock	90 cm
10295-01	Extension line with 3-way stopcock	100 cm
10296-01	Extension line with 3-way stopcock	120 cm
10297-01	Extension line with 3-way stopcock	150 cm

3-way stopcock with micro extension lines

REF 10699-01

Extension line with 3-way stopcock, microtubing, PVC free

Tube length: 15 cm

Tube diameter: 1 x 3.1 mm

Pack count: 1/25/100





Packaging & labeling

- Packed in high quality/high grammage medical grade paper and strong “multilayer” plastic film
- 3 layers of packaging throughout the range
- Labeling in accordance with ISO 15223-1 and EN1041 and respective product standard





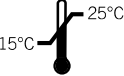





Packaging Symbols Explained

Storage symbols

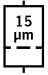
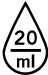
	Keep dry
	Keep away from sunlight
	Temperature limit
	Use by date

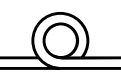
Symbols of product properties and components

	Does not contain Latex
	DEHP free
	PVC free
	Non-pyrogenic
	Liquid filter with pore size
	Drops per milliliter
	Sterilized using Ethylene Oxide
	Tube length
	3-way stopcock



Fluid path



Luer-lock







Needle free connector







One-way valve

Symbols of warning and instructions

	Do not re-use
	Do not use if package is damaged
	Do not re-sterilize
	Safe for use with pressure infusion equipment
	Gravity feed only

Symbols of product identification

	Catalogue number
	Batch code
	Date of manufacture
	Manufacturer

ONEMED

OneMed Group Oy

P.O.Box 10 (Metsäläntie 20), FI-00321 Helsinki

www.onemed.com

Phone +358 20 786 6800

evercare® inLine is a registered trademark of OneMed Group Oy